

PASSENGER ELEVATORS

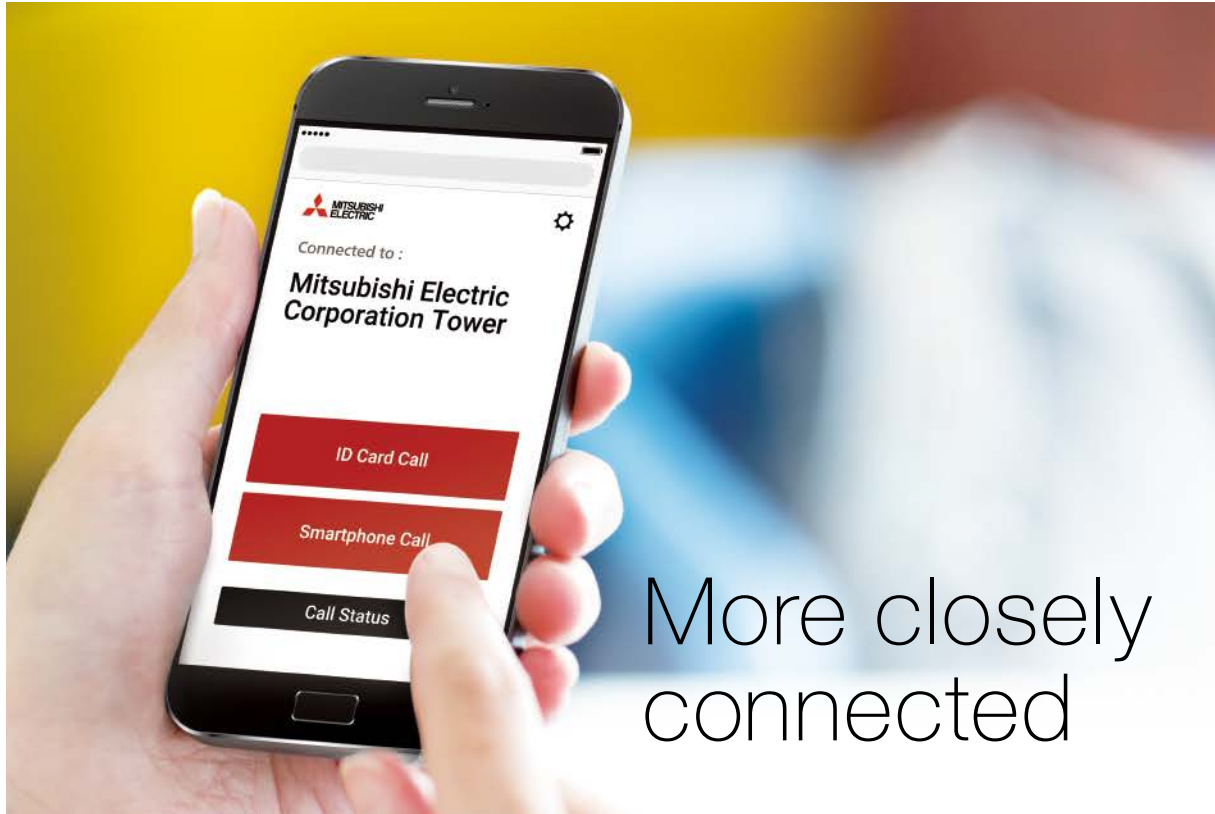

More closely  
connected

### Elevator Call System with Smartphone

This smartphone application is designed for users to easily access an elevator equipped with the DOAS® Integrated with Security System. Using a smartphone equipped with the application, users can change the call setting for their elevator and check the status of the elevator assigned to them. Once inside the secure area, users can call an elevator remotely from anywhere. The increased convenience and mobility bring more value to the building.

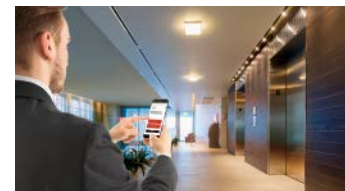

#### Convenient & Intuitive

This smartphone application delivers quicker and easier elevator use through convenient features, including ID Card Call and Smartphone Call for use before and after the security point in the building. The intuitive display design provides users with maximum support. (Please see backside of leaflet for function details.)

#### Enhanced Comfort & User Friendly

The smartphone displays the elevator assigned and its current status and alerts the passenger as the elevator car approaches to assist smooth boarding. Additionally, this application allows users to set a call mode for Smartphone Call, for example, to request a wheelchair accessible elevator.

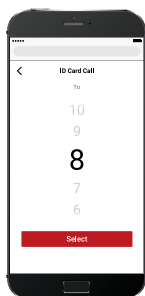

Before the building security point

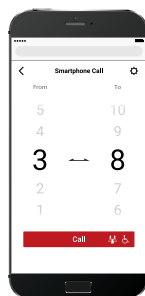

In the building

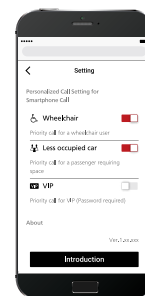

**Notes:**

- This function is an option for elevators equipped with the DOAS Integrated with Security System. For information on the DOAS Integrated with Security System, refer to the DAI-2200C brochure.
- Occupant management is required for this function to confirm the users are in the building. (Users having left the building cannot call an elevator.)

## Procedure

### ID Card Call function

When a user takes an elevator from the lobby floor, the user can change the destination floor from the default floor for the ID card by using their smartphone before reaching the security point.

Example: From 1F (lobby floor) to 8F (non-default destination floor)

Building security point (card authentication) Before / After

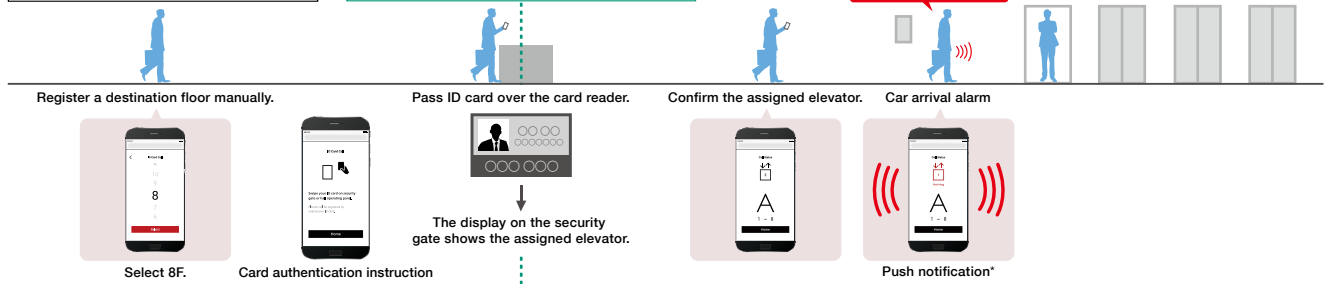

### Smartphone Call function

A person who has passed the security point can call an elevator using their smartphone to go to another floor.

Example: From 3F to 8F

Occupant management is required to confirm the user is in the building. (Users having left the building cannot call an elevator.)



Note:  
\* The alert method differs depending on the mobile platform.

Read this barcode for more details.



\* This system can be customized according to your needs. Please consult our local agents for details.

## System Configuration

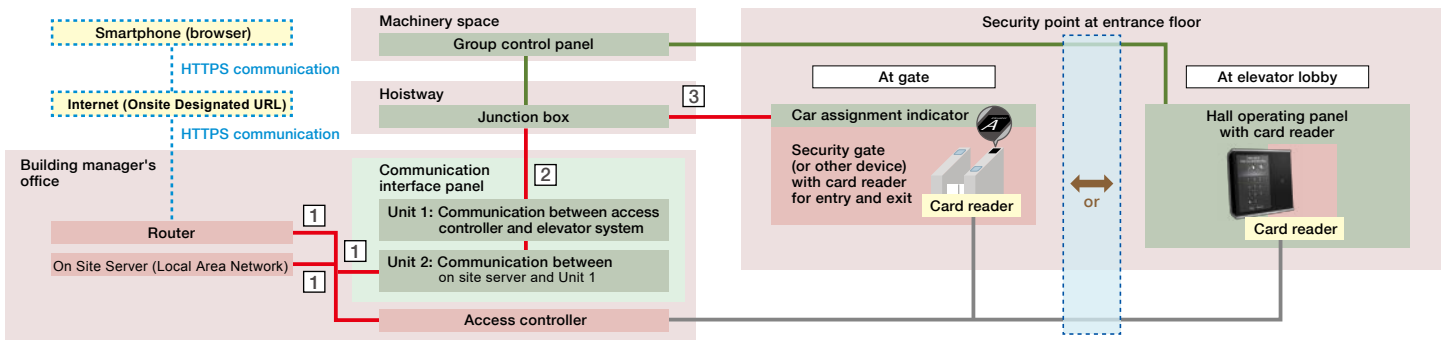

Notes:

\*1: Please consult our local agents for details of devices supplied by owner.

\*2: Refer to the AI-2200C brochure for Destination Oriented Allocation System (DOAS<sup>®</sup>) and DOAS<sup>®</sup> Integrated with Security

Device	Supplier	Cable	Supplier	Cable type and communication protocol
	Mitsubishi Electric		Mitsubishi Electric	See Specifications below
	Security system supplier		Security system supplier	See Specifications below
			Security system supplier	To be selected by the supplier

### ● Cable type and communication protocol

Wiring from access controller to junction box in hoistway (Main signal transmission)

- Cables between access controller and interface panel<sup>[1]</sup>: Ethernet (100BASE-TX),

Communication protocol: UDP/IP

- Cables between interface panel and junction box<sup>[2]</sup>: Minimum two twisted-pair cables (shielded)

Wiring for other devices

- Cables between junction box in hoistway and car assignment indicator<sup>[3]</sup>: Minimum two twisted-pair cables (shielded) (Consultation about power supply is required.)

- A terminal block is required for each security gate.

## Specifications

### ● Smartphone requirements

Function	Detail	
Web application	Operating system	Android or iOS
	Web browser	Safari, Google Chrome
	Language	English (Please consult our local agents for other languages.)

### ● Interface panel requirements

Size	300 (W) × 300 (H) × 100 (D) [mm]
Installation	The panel is to be installed on a wall. Secure a maintenance space of 700mm (including panel depth) on the front side and a clearance of 50mm on the right side of the panel. Wiring space must be secured as well.

### ● Applicable product scale

Item	Maximum
Elevator groups (per interface panel)	4 groups
Stops (per group)	64 stops
Access controllers	127 units
Card readers (per group)	255 units
Security gates (per floor in a group)	8 gates
Floors with security gates (per group)	2 floors

## Important

Close collaboration with the security system supplier and the Web server supplier is required for system integration. For more information, please consult our local agents.



### for a greener tomorrow

Eco Changes is the Mitsubishi Electric Group's environmental statement, and expresses the Group's stance on environmental management. Through a wide range of businesses, we are helping contribute to the realization of a sustainable society.

## Mitsubishi Electric US, Inc. Elevator/Escalator Division

Tel: 800-988-8474 / 5900-A Katella Avenue, Cypress, California 90630, U.S.A.

Website: [www.mitsubishielevator.com](http://www.mitsubishielevator.com) Email: [EEDSALES@meus.mea.com](mailto:EEDSALES@meus.mea.com)

## MITSUBISHI ELECTRIC CORPORATION

HEAD OFFICE : TOKYO BLDG., 2-7-3, MARUNOUCHI, CHIYODA-KU, TOKYO 100-8310, JAPAN

[www.MitsubishiElectric.com/elevator](http://www.MitsubishiElectric.com/elevator)

**⚠ Safety Tips:** Be sure to read the instruction manual fully before using this product.

Revised publication effective Jan. 2020.  
Superseding publication of C-CL1-9-BA328-A Mar. 2019.  
Specifications are subject to change without notice.

©2020 Mitsubishi Electric Corporation